







LEGENDE NUTSVORZIENINGEN

-  aftappunt hemelwater - RW pomp
-  stadswater
-  wachtbuizen
-  hemelwater
-  fecaliën
-  huishoudelijk

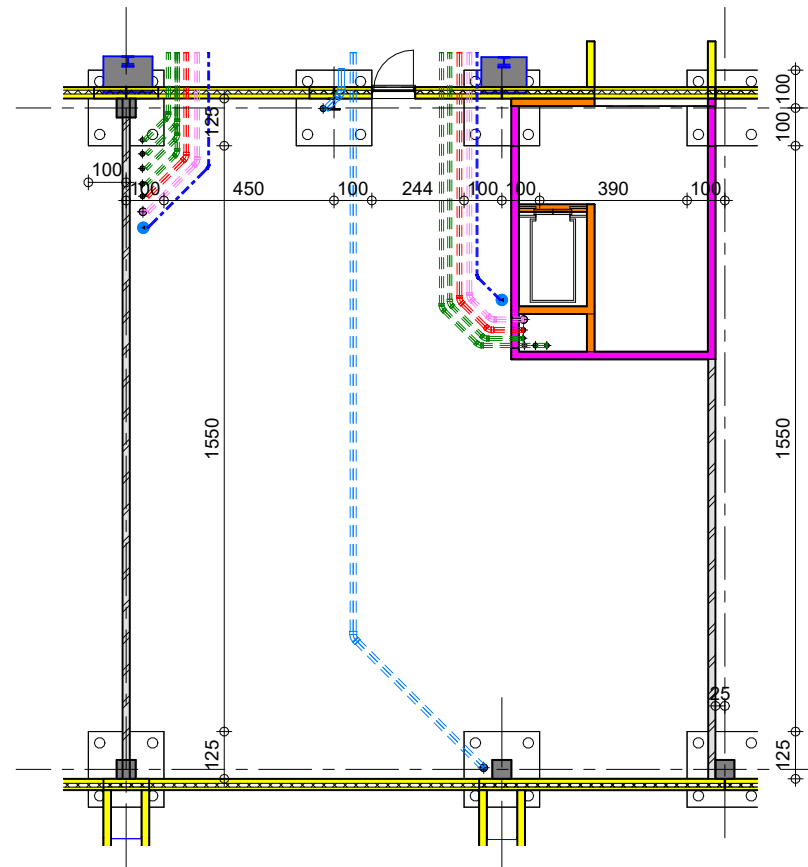

FUNDERING RIOLERING

1 : 200

maatvoering in cm
hoogtepeilen in m

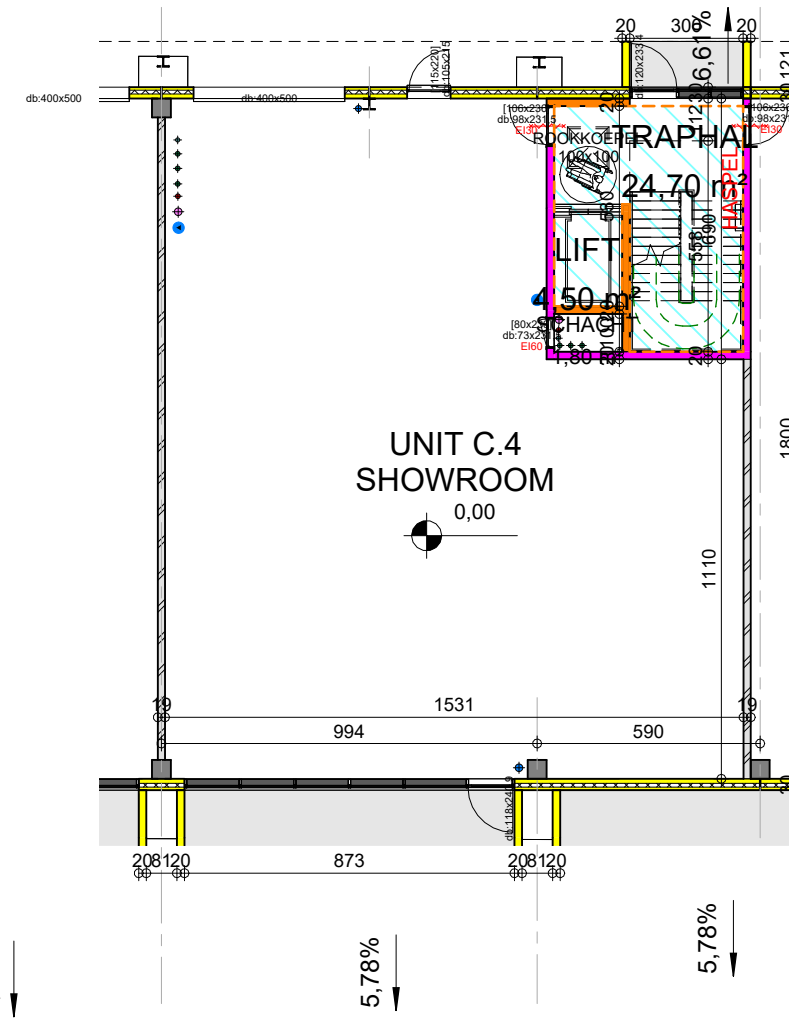
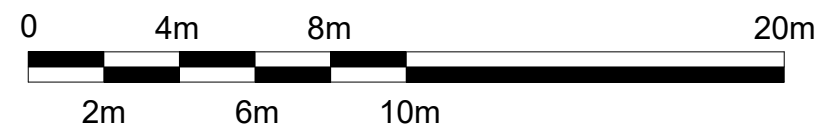

GELIJKVLOERS

1 : 200

maatvoering in cm
hoogtepeilen in m

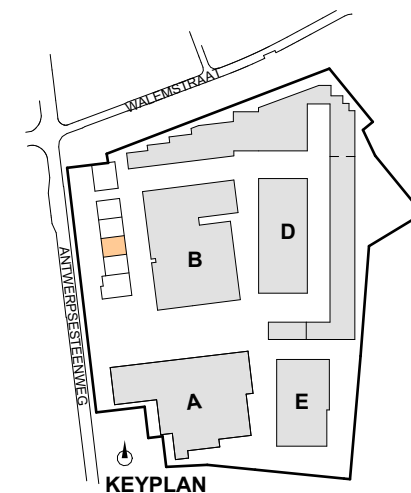
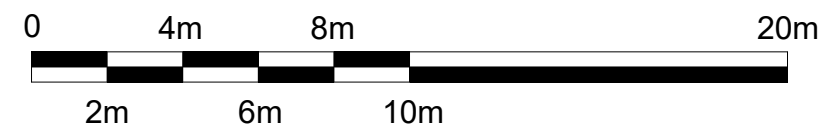

1634/22 MARTAL BEDRIJVENCENTRUM

Unit C.4

26/04/2024 nSA

COM/C04/a

As indicated

ARCHITECTENBUREAU WIL-MA BVBA
GENEINDE 221 - 2260 WESTERLO
T: +32 14 26 47 01
info@wilmawastiau.com
W. ALLEN ZIMMERMAN - MARIE WASTIAU

WILMA WASTIAU
WILMA WASTIAU | WE FUNK INDUSTRIAL ARCHITECTURE



DIT PLAN IS EIGENDOM VAN HET ARCHITECTENBUREAU. HET MAG NIET GEKOPIEERD OF AAN DERDEN DOORGEGEVEN WORDEN ZONDER ONZE TOESTEMMING. OPGEGEVEN MATEN ZIJN INDICATIEF.